

Baseline Assessment – Stream Attributes

**Additional information was collected on 1/14/2022.*

Reach S-EF57 (Temporary Access Road) * Intermittent Spread H Roanoke County, Virginia

Data	Included
Photos	✓*
SWVM Form	✓*
FCI Calculator and HGM Form	✓*
RBP Physical Characteristics Form	✓*
Water Quality Data	✓*
RBP Habitat Form	✓*
RBP Benthic Form	✓*
Benthic Identification Sheet	N/A- No riffles within reach
Wolman Pebble Count	✓*
RiverMorph Data Sheet	✓*
USM Form (Virginia Only)	✓
Longitudinal Profile and Cross Sections	✓



Photo Type: DS VIEW

Location, Orientation, Photographer Initials: Downstream view of LOC looking S, SB



Photo Type: US VIEW

Location, Orientation, Photographer Initials: Upstream view of LOC looking N, SB



Photo Type: CL ACCESS 1
Location, Orientation, Photographer Initials: Standing in Access Road looking E, SB



Photo Type: CL ACCESS 2
Location, Orientation, Photographer Initials: Standing in Access Road looking W, SB



Photo Type: DS COND

Location, Orientation, Photographer Initials: Downstream conditions outside of LOC looking S, SB

L:\22000s\22800\22865.06\Admin\05-ENVR\Field Data\Spread H\Field Forms\S-EF57\1_QAQC\S-EF57_Photo Document.docx

Spread H Stream S-E57 (Temporary AR) Roanoke County



Photo Type: DS VIEW
Location, Orientation, Photographer Initials: Downstream view of LOC looking E/SE, KB



Photo Type: US VIEW
Location, Orientation, Photographer Initials: Upstream view of LOC looking N/NW, KB



Photo Type: CL ACCESS 1

Location, Orientation, Photographer Initials: Standing in Access Road looking E/NE, KB



Photo Type: CL ACCESS 2

Location, Orientation, Photographer Initials: Standing in Access Road looking W/SW, KB



Photo Type: DS COND

Location, Orientation, Photographer Initials: Downstream conditions outside of LOC looking S, KB

USACE FILE NO/ Project Name: <small>(V2.1, Sept 2015)</small>		Mountain Valley Pipeline		IMPACT COORDINATES: (in Decimal Degrees)		Lat.	37.181736	Lon.	-80.148948	WEATHER:		Sunny		DATE:		January 14, 2022			
IMPACT STREAM/SITE ID AND SITE DESCRIPTION: <small>(watershed size (acres), unaltered or impairments)</small>				S-EF57, Drainage Area= 20.31 ac				MITIGATION STREAM CLASS/SITE ID AND SITE DESCRIPTION: <small>(watershed size (acres), unaltered or impairments)</small>				Comments:							
STREAM IMPACT LENGTH:		42		FORM OF MITIGATION:		RESTORATION (Levels I-III)		MIT COORDINATES: (in Decimal Degrees)		Lat.		Lon.		PRECIPITATION PAST 48 HRS:		Trace		Mitigation Length:	
Column No. 1- Impact Existing Condition (Debit)				Column No. 2- Mitigation Existing Condition - Baseline (Credit)				Column No. 3- Mitigation Projected at Five Years Post Completion (Credit)				Column No. 4- Mitigation Projected at Ten Years Post Completion (Credit)				Column No. 5- Mitigation Projected at Maturity (Credit)			
Stream Classification: Intermittent				Stream Classification:				Stream Classification: 0				Stream Classification: 0				Stream Classification: 0			
Percent Stream Channel Slope 13.8				Percent Stream Channel Slope				Percent Stream Channel Slope 0				Percent Stream Channel Slope 0				Percent Stream Channel Slope 0			
HGM Score (attach data forms):				HGM Score (attach data forms):				HGM Score (attach data forms):				HGM Score (attach data forms):				HGM Score (attach data forms):			
Average				Average				Average				Average				Average			
Hydrology 0.92				Hydrology				Hydrology				Hydrology				Hydrology			
Biogeochemical Cycling 0.63				Biogeochemical Cycling 0				Biogeochemical Cycling 0				Biogeochemical Cycling 0				Biogeochemical Cycling 0			
Habitat 0.64				Habitat				Habitat				Habitat				Habitat			
PART I - Physical, Chemical and Biological Indicators				PART I - Physical, Chemical and Biological Indicators				PART I - Physical, Chemical and Biological Indicators				PART I - Physical, Chemical and Biological Indicators				PART I - Physical, Chemical and Biological Indicators			
PHYSICAL INDICATOR (Applies to all streams classifications)				PHYSICAL INDICATOR (Applies to all streams classifications)				PHYSICAL INDICATOR (Applies to all streams classifications)				PHYSICAL INDICATOR (Applies to all streams classifications)				PHYSICAL INDICATOR (Applies to all streams classifications)			
USEPA RBP (High Gradient Data Sheet)				USEPA RBP (Low Gradient Data Sheet)				USEPA RBP (High Gradient Data Sheet)				USEPA RBP (High Gradient Data Sheet)				USEPA RBP (High Gradient Data Sheet)			
1. Epifaunal Substrate/Available Cover 0-20 18				1. Epifaunal Substrate/Available Cover 0-20				1. Epifaunal Substrate/Available Cover 0-20				1. Epifaunal Substrate/Available Cover 0-20				1. Epifaunal Substrate/Available Cover 0-20			
2. Embeddedness 0-20 19				2. Embeddedness 0-20				2. Embeddedness 0-20				2. Embeddedness 0-20				2. Embeddedness 0-20			
3. Velocity/Depth Regime 0-20 16				3. Velocity/Depth Regime 0-20				3. Velocity/Depth Regime 0-20				3. Velocity/Depth Regime 0-20				3. Velocity/Depth Regime 0-20			
4. Sediment Deposition 0-20 20				4. Sediment Deposition 0-20				4. Sediment Deposition 0-20				4. Sediment Deposition 0-20				4. Sediment Deposition 0-20			
5. Channel Flow Status 0-20 15				5. Channel Flow Status 0-20				5. Channel Flow Status 0-20				5. Channel Flow Status 0-20				5. Channel Flow Status 0-20			
6. Channel Alteration 0-20 20				6. Channel Alteration 0-20				6. Channel Alteration 0-20				6. Channel Alteration 0-20				6. Channel Alteration 0-20			
7. Frequency of Riffles (or bends) 0-20 19				7. Channel Sinuosity 0-20				7. Frequency of Riffles (or bends) 0-20				7. Frequency of Riffles (or bends) 0-20				7. Frequency of Riffles (or bends) 0-20			
8. Bank Stability (LB & RB) 0-20 20				8. Bank Stability (LB & RB) 0-20				8. Bank Stability (LB & RB) 0-20				8. Bank Stability (LB & RB) 0-20				8. Bank Stability (LB & RB) 0-20			
9. Vegetative Protection (LB & RB) 0-20 20				9. Vegetative Protection (LB & RB) 0-20				9. Vegetative Protection (LB & RB) 0-20				9. Vegetative Protection (LB & RB) 0-20				9. Vegetative Protection (LB & RB) 0-20			
10. Riparian Vegetative Zone Width (LB & RB) 0-20 20				10. Riparian Vegetative Zone Width (LB & RB) 0-20				10. Riparian Vegetative Zone Width (LB & RB) 0-20				10. Riparian Vegetative Zone Width (LB & RB) 0-20				10. Riparian Vegetative Zone Width (LB & RB) 0-20			
Total RBP Score Optimal 187				Total RBP Score Poor 0				Total RBP Score Poor 0				Total RBP Score Poor 0				Total RBP Score Poor 0			
Sub-Total 0.935				Sub-Total 0				Sub-Total 0				Sub-Total 0				Sub-Total 0			
CHEMICAL INDICATOR (Applies to Intermittent and Perennial Streams)				CHEMICAL INDICATOR (Applies to Intermittent and Perennial Streams)				CHEMICAL INDICATOR (Applies to Intermittent and Perennial Streams)				CHEMICAL INDICATOR (Applies to Intermittent and Perennial Streams)				CHEMICAL INDICATOR (Applies to Intermittent and Perennial Streams)			
WVDEP Water Quality Indicators (General)				WVDEP Water Quality Indicators (General)				WVDEP Water Quality Indicators (General)				WVDEP Water Quality Indicators (General)				WVDEP Water Quality Indicators (General)			
Specific Conductivity				Specific Conductivity				Specific Conductivity				Specific Conductivity				Specific Conductivity			
<=99 = 90 points 0-90 31.8				<=99 = 90 points 0-90				<=99 = 90 points 0-90				<=99 = 90 points 0-90				<=99 = 90 points 0-90			
pH				pH				pH				pH				pH			
6.0-8.0 = 80 points 0-80 7				6.0-8.0 = 80 points 0-80				6.0-8.0 = 80 points 0-80				6.0-8.0 = 80 points 0-80				6.0-8.0 = 80 points 0-80			
DO				DO				DO				DO				DO			
>5.0 = 30 points 10-30 51.2				>5.0 = 30 points 10-30				>5.0 = 30 points 10-30				>5.0 = 30 points 10-30				>5.0 = 30 points 10-30			
Sub-Total 1				Sub-Total 0				Sub-Total 0				Sub-Total 0				Sub-Total 0			
BIOLOGICAL INDICATOR (Applies to Intermittent and Perennial Streams)				BIOLOGICAL INDICATOR (Applies to Intermittent and Perennial Streams)				BIOLOGICAL INDICATOR (Applies to Intermittent and Perennial Streams)				BIOLOGICAL INDICATOR (Applies to Intermittent and Perennial Streams)				BIOLOGICAL INDICATOR (Applies to Intermittent and Perennial Streams)			
WV Stream Condition Index (WVSCI)				WV Stream Condition Index (WVSCI)				WV Stream Condition Index (WVSCI)				WV Stream Condition Index (WVSCI)				WV Stream Condition Index (WVSCI)			
0 0-100 0-1 0				0 0-100 0-1				0 0-100 0-1				0 0-100 0-1				0 0-100 0-1			
Sub-Total 0				Sub-Total 0				Sub-Total 0				Sub-Total 0				Sub-Total 0			
PART II - Index and Unit Score				PART II - Index and Unit Score				PART II - Index and Unit Score				PART II - Index and Unit Score				PART II - Index and Unit Score			
Index Linear Feet Unit Score				Index Linear Feet Unit Score				Index Linear Feet Unit Score				Index Linear Feet Unit Score				Index Linear Feet Unit Score			
0.849 42 35.6475				0 0 0				0 0 0				0 0 0				0 0 0			

FCI Calculator for the High-Gradient Headwater Streams in Appalachia

To ensure accurate calculations, the **UPPERMOST STRATUM** of the plant community is determined based on the calculated value for $V_{CCANOPY}$ ($\geq 20\%$ cover is required for tree/sapling strata). Go to the SAR Data Entry tab and enter site characteristics and data in the yellow cells. For information on determining how to split a project into SARs, see Chapter 5 of the Operational Draft Regional Guidebook for the Functional Assessment of High-Gradient Headwater Streams and Low-Gradient Perennial Streams in Appalachia (Environmental Laboratory U.S. Army Corps of Engineers 2017).

Project Name: Mountain Valley Pipeline

Location: Roanoke County

Sampling Date: 1/14/2022

Project Site Before Project

Subclass for this SAR:

Intermittent Stream

Uppermost stratum present at this SAR:

Shrub/Herb Strata

SAR number: S-EF57

Functional Results Summary:

Enter Results in Section A of the Mitigation Sufficiency Calculator

Function	Functional Capacity Index
Hydrology	0.92
Biogeochemical Cycling	0.63
Habitat	0.64

Variable Measure and Subindex Summary:

Variable	Name	Average Measure	Subindex
$V_{CCANOPY}$	Percent canopy over channel.	Not Used, <20%	Not Used
V_{EMBED}	Average embeddedness of channel.	3.30	0.93
$V_{SUBSTRATE}$	Median stream channel substrate particle size.	2.75	1.00
V_{BERO}	Total percent of eroded stream channel bank.	0.00	1.00
V_{LWD}	Number of down woody stems per 100 feet of stream.	40.48	0.74
V_{TDBH}	Average dbh of trees.	Not Used	Not Used
V_{SNAG}	Number of snags per 100 feet of stream.	0.00	0.10
V_{SSD}	Number of saplings and shrubs per 100 feet of stream.	166.67	1.00
V_{SRICH}	Riparian vegetation species richness.	2.49	1.00
$V_{DETRITUS}$	Average percent cover of leaves, sticks, etc.	23.75	0.29
V_{HERB}	Average percent cover of herbaceous vegetation.	60.00	0.80
V_{WLUSE}	Weighted Average of Runoff Score for Catchment.	1.00	1.00

High-Gradient Headwater Streams in Appalachia Field Data Sheet and Calculator

Team: **KB AB** Latitude/UTM Northing: **37.181736**
 Project Name: **Mountain Valley Pipeline** Longitude/UTM Easting: **-80.148948**
 Location: **Roanoke County** Sampling Date: **1/14/2022**
 SAR Number: **S-EF57** Reach Length (ft): **42** Stream Type: **Intermittent Stream**

Top Strata: **Shrub/Herb Strata** (determined from percent calculated in $V_{CCANOPY}$)

Site and Timing: **Project Site** Before Project

Sample Variables 1-4 in stream channel

1 $V_{CCANOPY}$ Average percent cover over channel by tree and sapling canopy. Measure at no fewer than 10 roughly equidistant points along the stream. Measure only if tree/sapling cover is at least 20%. (If less than 20%, enter at least one value between 0 and 19 to trigger Top Strata choice.) Not Used, <20%

List the percent cover measurements at each point below:

0									

2 V_{EMBED} Average embeddedness of the stream channel. Measure at no fewer than 30 roughly equidistant points along the stream. Select a particle from the bed. Before moving it, determine the percentage of the surface and area surrounding the particle that is covered by fine sediment, and enter the rating according to the following table. If the bed is an artificial surface, or composed of fine sediments, use a rating score of 1. If the bed is composed of bedrock, use a rating score of 5. 3.3

Embeddedness rating for gravel, cobble and boulder particles (rescaled from Platts, Megahan, and Minshall 1983)

Rating	Rating Description
5	<5 percent of surface covered, surrounded, or buried by fine sediment (or bedrock)
4	5 to 25 percent of surface covered, surrounded, or buried by fine sediment
3	26 to 50 percent of surface covered, surrounded, or buried by fine sediment
2	51 to 75 percent of surface covered, surrounded, or buried by fine sediment
1	>75 percent of surface covered, surrounded, or buried by fine sediment (or artificial surface)

List the ratings at each point below:

5	2								
3	1								
4	4								
5	5								
2	2								

Measure at least 30 points

3 $V_{SUBSTRATE}$ Median stream channel substrate particle size. Measure at no fewer than 30 roughly equidistant points along the stream; use the same points and particles as used in V_{EMBED} . 2.75 in

Enter particle size in inches to the nearest 0.1 inch at each point below (bedrock should be counted as 99 in, asphalt or concrete as 0.0 in, sand or finer particles as 0.08 in):

6.00	7.00								
2.00	99.00								
0.40	0.10								
3.50	5.00								
0.20	0.10								

4 V_{BERO} Total percent of eroded stream channel bank. Enter the total number of feet of eroded bank on each side and the total percentage will be calculated. If both banks are eroded, total erosion for the stream may be up to 200%. 0 %

Left Bank: **0 ft** Right Bank: **0 ft**

Sample Variables 5-9 within the entire riparian/buffer zone adjacent to the stream channel (25 feet from each bank).

5 V_{LWD} Number of down woody stems (at least 4 inches in diameter and 36 inches in length) per 100 feet of stream reach. Enter the number from the entire 50'-wide buffer and within the channel, and the amount per 100 feet of stream will be calculated. 40.5

Number of downed woody stems: **17**

6 V_{TDBH} Average dbh of trees (measure only if $V_{CCANOPY}$ tree/sapling cover is at least 20%). Trees are at least 4 inches (10 cm) in diameter. Enter tree DBHs in inches. Not Used

List the dbh measurements of individual trees (at least 4 in) within the buffer on each side of the stream below:

Left Side					Right Side				

7 V_{SNAG} Number of snags (at least 4" dbh and 36" tall) per 100 feet of stream. Enter number of snags on each side of the stream, and the amount per 100 feet will be calculated. 0.0

Left Side: **0** Right Side: **0**

8 V_{SSD} Number of saplings and shrubs (woody stems up to 4 inches dbh) per 100 feet of stream (measure only if tree cover is <20%). Enter number of saplings and shrubs on each side of the stream, and the amount per 100 ft of stream will be calculated. 166.7

Left Side: **35** Right Side: **35**

9	V _{SRICH}	Riparian vegetation species richness per 100 feet of stream reach. Check all species present from Group 1 in the tallest stratum. Check all exotic and invasive species present in all strata. Species richness per 100 feet and the subindex will be calculated from these data.	2.49
Group 1 = 1.0		Group 2 (-1.0)	
<input type="checkbox"/>	<i>Acer rubrum</i>	<input type="checkbox"/>	<i>Magnolia tripetala</i>
<input type="checkbox"/>	<i>Acer saccharum</i>	<input type="checkbox"/>	<i>Nyssa sylvatica</i>
<input type="checkbox"/>	<i>Aesculus flava</i>	<input type="checkbox"/>	<i>Oxydendrum arboreum</i>
<input type="checkbox"/>	<i>Asimina triloba</i>	<input checked="" type="checkbox"/>	<i>Prunus serotina</i>
<input type="checkbox"/>	<i>Betula alleghaniensis</i>	<input checked="" type="checkbox"/>	<i>Quercus alba</i>
<input type="checkbox"/>	<i>Betula lenta</i>	<input type="checkbox"/>	<i>Quercus coccinea</i>
<input type="checkbox"/>	<i>Carya alba</i>	<input type="checkbox"/>	<i>Quercus imbricaria</i>
<input type="checkbox"/>	<i>Carya glabra</i>	<input type="checkbox"/>	<i>Quercus prinus</i>
<input type="checkbox"/>	<i>Carya ovalis</i>	<input type="checkbox"/>	<i>Quercus rubra</i>
<input type="checkbox"/>	<i>Carya ovata</i>	<input type="checkbox"/>	<i>Quercus velutina</i>
<input type="checkbox"/>	<i>Cornus florida</i>	<input type="checkbox"/>	<i>Sassafras albidum</i>
<input type="checkbox"/>	<i>Fagus grandifolia</i>	<input type="checkbox"/>	<i>Tilia americana</i>
<input checked="" type="checkbox"/>	<i>Fraxinus americana</i>	<input type="checkbox"/>	<i>Tsuga canadensis</i>
<input checked="" type="checkbox"/>	<i>Liriodendron tulipifera</i>	<input type="checkbox"/>	<i>Ulmus americana</i>
<input type="checkbox"/>	<i>Magnolia acuminata</i>		
4 Species in Group 1		2 Species in Group 2	

Sample Variables 10-11 within at least 8 subplots (40" x 40", or 1m x 1m) in the riparian/buffer zone within 25 feet from each bank. The four subplots should be placed roughly equidistantly along each side of the stream.

10	V _{DETRITUS}	Average percent cover of leaves, sticks, or other organic material. Woody debris <4" diameter and <36" long are include. Enter the percent cover of the detrital layer at each subplot.	23.75 %																								
		<table border="1"> <tr> <th colspan="4">Left Side</th> <th colspan="4">Right Side</th> </tr> <tr> <td>40</td><td></td><td></td><td></td> <td>10</td><td></td><td></td><td></td> </tr> <tr> <td>40</td><td></td><td></td><td></td> <td>5</td><td></td><td></td><td></td> </tr> </table>	Left Side				Right Side				40				10				40				5				
Left Side				Right Side																							
40				10																							
40				5																							
11	V _{HERB}	Average percentage cover of herbaceous vegetation (measure only if tree cover is <20%). Do not include woody stems at least 4" dbh and 36" tall. Because there may be several layers of ground cover vegetation percentages up through 200% are accepted. Enter the percent cover of ground vegetation at each subplot.	60 %																								
		<table border="1"> <tr> <th colspan="4">Left Side</th> <th colspan="4">Right Side</th> </tr> <tr> <td>60</td><td></td><td></td><td></td> <td>90</td><td></td><td></td><td></td> </tr> <tr> <td>10</td><td></td><td></td><td></td> <td>80</td><td></td><td></td><td></td> </tr> </table>	Left Side				Right Side				60				90				10				80				
Left Side				Right Side																							
60				90																							
10				80																							

Sample Variable 12 within the entire catchment of the stream.

12	V _{WLUSE}	Weighted Average of Runoff Score for watershed:	1.00																																								
		<table border="1"> <thead> <tr> <th>Land Use (Choose From Drop List)</th> <th>Runoff Score</th> <th>% in Catchment</th> <th>Running Percent (not >100)</th> </tr> </thead> <tbody> <tr> <td>Forest and native range (>75% ground cover)</td> <td>1</td> <td>100</td> <td>100</td> </tr> <tr> <td></td> <td></td> <td></td> <td></td> </tr> <tr> <td></td> <td></td> <td></td> <td></td> </tr> <tr> <td></td> <td></td> <td></td> <td></td> </tr> <tr> <td></td> <td></td> <td></td> <td></td> </tr> <tr> <td></td> <td></td> <td></td> <td></td> </tr> <tr> <td></td> <td></td> <td></td> <td></td> </tr> <tr> <td></td> <td></td> <td></td> <td></td> </tr> <tr> <td></td> <td></td> <td></td> <td></td> </tr> </tbody> </table>	Land Use (Choose From Drop List)	Runoff Score	% in Catchment	Running Percent (not >100)	Forest and native range (>75% ground cover)	1	100	100																																	
Land Use (Choose From Drop List)	Runoff Score	% in Catchment	Running Percent (not >100)																																								
Forest and native range (>75% ground cover)	1	100	100																																								

S-EF57			Notes:
Variable	Value	VSI	Land Cover Analysis was completed using the 2019 National Land Cover Database (NLCD), from Landsat satellite imagery and other supplementary datasets. Watershed boundaries are based off of field delineated stream impacts. *Percentages in catchment values have been rounded to the nearest whole number.
V _{CCANOPY}	Not Used, <20%	Not Used	
V _{EMBED}	3.3	0.93	
V _{SUBSTRATE}	2.75 in	1.00	
V _{BERO}	0 %	1.00	
V _{LWD}	40.5	0.74	
V _{TDBH}	Not Used	Not Used	
V _{SNAG}	0.0	0.10	
V _{SSD}	166.7	1.00	
V _{SRICH}	2.49	1.00	
V _{DETRITUS}	23.8 %	0.29	
V _{HERB}	60 %	0.80	
V _{WLUSE}	1	1.00	

PHYSICAL CHARACTERIZATION/WATER QUALITY FIELD DATA SHEET (BACK)

WATERSHED FEATURES	Predominant Surrounding Landuse <input checked="" type="checkbox"/> Forest <input type="checkbox"/> Commercial <input checked="" type="checkbox"/> Field/Pasture <input type="checkbox"/> Industrial <input type="checkbox"/> Agricultural <input type="checkbox"/> Other _____ <input type="checkbox"/> Residential	Local Watershed NPS Pollution <input checked="" type="checkbox"/> No evidence <input type="checkbox"/> Some potential sources <input type="checkbox"/> Obvious sources Local Watershed Erosion <input checked="" type="checkbox"/> None <input type="checkbox"/> Moderate <input type="checkbox"/> Heavy
RIPARIAN VEGETATION (18 meter buffer)	Indicate the dominant type and record the dominant species present <input type="checkbox"/> Trees <input checked="" type="checkbox"/> Shrubs <input type="checkbox"/> Grasses <input type="checkbox"/> Herbaceous Dominant species present Black Cherry and Mountain Laurel	
INSTREAM FEATURES	Estimated Reach Length 11.58 m Estimated Stream Width 0.9 m Sampling Reach Area 10.4 m ² Area in km² (m²x1000) _____ km ² Estimated Stream Depth 0.61 m Surface Velocity (at thalweg) N/A m/sec	Canopy Cover <input type="checkbox"/> Partly open <input checked="" type="checkbox"/> Partly shaded <input type="checkbox"/> Shaded High Water Mark 0.23 m Proportion of Reach Represented by Stream Morphology Types Riffle ²⁰ _____ % Run ²⁰ _____ % Pool ⁶⁰ _____ % Channelized <input type="checkbox"/> Yes <input checked="" type="checkbox"/> No Dam Present <input type="checkbox"/> Yes <input checked="" type="checkbox"/> No
LARGE WOODY DEBRIS	LWD 4 m ² Density of LWD _____ m ² /km ² (LWD/ reach area)	
AQUATIC VEGETATION	Indicate the dominant type and record the dominant species present <input type="checkbox"/> Rooted emergent <input type="checkbox"/> Rooted submergent <input type="checkbox"/> Rooted floating <input type="checkbox"/> Free floating <input type="checkbox"/> Floating Algae <input checked="" type="checkbox"/> Attached Algae Dominant species present Unknown Portion of the reach with aquatic vegetation 5 %	
WATER QUALITY	Temperature ⁹ _____ °C Specific Conductance ^{1.8 uS/cm} 5 Dissolved Oxygen ⁵ 1.2 mg/L pH 5 Turbidity ⁵ N/A 5 WQ Instrument Used YSI #4	Water Odors <input checked="" type="checkbox"/> Normal/None <input type="checkbox"/> Sewage <input type="checkbox"/> Petroleum <input type="checkbox"/> Chemical <input type="checkbox"/> Fishy <input type="checkbox"/> Other _____ Water Surface Oils <input type="checkbox"/> Slick <input type="checkbox"/> Sheen <input type="checkbox"/> Globs Flecks <input checked="" type="checkbox"/> None <input type="checkbox"/> Other _____ Turbidity (if not measured) <input checked="" type="checkbox"/> Clear <input type="checkbox"/> Slightly turbid <input type="checkbox"/> Turbid <input type="checkbox"/> Opaque <input type="checkbox"/> Stained <input type="checkbox"/> Other _____
SEDIMENT/SUBSTRATE	Odors <input checked="" type="checkbox"/> Normal <input type="checkbox"/> Sewage <input type="checkbox"/> Petroleum <input type="checkbox"/> Chemical <input type="checkbox"/> Anaerobic <input type="checkbox"/> None <input type="checkbox"/> Other _____ Oils <input checked="" type="checkbox"/> Absent <input type="checkbox"/> Slight <input type="checkbox"/> Moderate <input type="checkbox"/> Profuse Deposits <input type="checkbox"/> Sludge <input type="checkbox"/> Sawdust <input type="checkbox"/> Paper fiber <input type="checkbox"/> Sand <input type="checkbox"/> Relict shells <input type="checkbox"/> Other _____ Looking at stones which are not deeply embedded, are the undersides black in color? <input type="checkbox"/> Yes <input checked="" type="checkbox"/> No	

INORGANIC SUBSTRATE COMPONENTS (should add up to 100%)			ORGANIC SUBSTRATE COMPONENTS (does not necessarily add up to 100%)		
Substrate Type	Diameter	% Composition in Sampling Reach	Substrate Type	Characteristic	% Composition in Sampling Area
Bedrock			Detritus	sticks, wood, coarse plant materials (CPOM)	15
Boulder	> 256 mm (10")				
Cobble	64-256 mm (2.5"-10")	60	Muck-Mud	black, very fine organic (FPOM)	
Gravel	2-64 mm (0.1"-2.5")	30			
Sand	0.06-2mm (gritty)	10	Marl	grey, shell fragments	
Silt	0.004-0.06 mm				
Clay	< 0.004 mm (slick)				

HABITAT ASSESSMENT FIELD DATA SHEET - HG - USE ON ALL STREAMS (FRONT)

STREAM NAME S-EF57		LOCATION Roanoke County	
STATION # <u>281.02</u> RIVERMILE _____		STREAM CLASS Intermittent	
LAT <u>37.181736</u> LONG <u>-80.148948</u>		RIVER BASIN Upper Roanoke	
STORET # _____		AGENCY VADEQ	
INVESTIGATORS AB / KB			
FORM COMPLETED BY AB / KB		DATE <u>1/14/2022</u> TIME <u>11:29AM</u> AM PM	REASON FOR SURVEY Baseline Assessment

Habitat Parameter	Condition Category			
	Optimal	Suboptimal	Marginal	Poor
1. Epifaunal Substrate/ Available Cover SCORE 18	Greater than 70% of substrate favorable for epifaunal colonization and fish cover; mix of snags, submerged logs, undercut banks, cobble or other stable habitat and at stage to allow full colonization potential (i.e., logs/snags that are <u>not</u> new fall and <u>not</u> transient).	40-70% mix of stable habitat; well-suited for full colonization potential; adequate habitat for maintenance of populations; presence of additional substrate in the form of newfall, but not yet prepared for colonization (may rate at high end of scale).	20-40% mix of stable habitat; habitat availability less than desirable; substrate frequently disturbed or removed.	Less than 20% stable habitat; lack of habitat is obvious; substrate unstable or lacking.
	20 19 18 17 16	15 14 13 12 11	10 9 8 7 6	5 4 3 2 1 0
2. Embeddedness SCORE 19	Gravel, cobble, and boulder particles are 0-25% surrounded by fine sediment. Layering of cobble provides diversity of niche space.	Gravel, cobble, and boulder particles are 25-50% surrounded by fine sediment.	Gravel, cobble, and boulder particles are 50-75% surrounded by fine sediment.	Gravel, cobble, and boulder particles are more than 75% surrounded by fine sediment.
	20 19 18 17 16	15 14 13 12 11	10 9 8 7 6	5 4 3 2 1 0
3. Velocity/Depth Regime SCORE 16	All four velocity/depth regimes present (slow-deep, slow-shallow, fast-deep, fast-shallow). (Slow is < 0.3 m/s, deep is > 0.5 m.)	Only 3 of the 4 regimes present (if fast-shallow is missing, score lower than if missing other regimes).	Only 2 of the 4 habitat regimes present (if fast-shallow or slow-shallow are missing, score low).	Dominated by 1 velocity/depth regime (usually slow-deep).
	20 19 18 17 16	15 14 13 12 11	10 9 8 7 6	5 4 3 2 1 0
4. Sediment Deposition SCORE 20	Little or no enlargement of islands or point bars and less than 5% of the bottom affected by sediment deposition.	Some new increase in bar formation, mostly from gravel, sand or fine sediment; 5-30% of the bottom affected; slight deposition in pools.	Moderate deposition of new gravel, sand or fine sediment on old and new bars; 30-50% of the bottom affected; sediment deposits at obstructions, constrictions, and bends; moderate deposition of pools prevalent.	Heavy deposits of fine material, increased bar development; more than 50% of the bottom changing frequently; pools almost absent due to substantial sediment deposition.
	20 19 18 17 16	15 14 13 12 11	10 9 8 7 6	5 4 3 2 1 0
5. Channel Flow Status SCORE 15	Water reaches base of both lower banks, and minimal amount of channel substrate is exposed.	Water fills >75% of the available channel; or <25% of channel substrate is exposed.	Water fills 25-75% of the available channel, and/or riffle substrates are mostly exposed.	Very little water in channel and mostly present as standing pools.
	20 19 18 17 16	15 14 13 12 11	10 9 8 7 6	5 4 3 2 1 0

Notes: Stream crossing on walking trail off access road 281.02. No impact.

HABITAT ASSESSMENT FIELD DATA SHEET—HIGH GRADIENT STREAMS (BACK)

Habitat Parameter	Condition Category																			
	Optimal					Suboptimal					Marginal					Poor				
6. Channel Alteration SCORE 20	Channelization or dredging absent or minimal; stream with normal pattern.					Some channelization present, usually in areas of bridge abutments; evidence of past channelization, i.e., dredging, (greater than past 20 yr) may be present, but recent channelization is not present.					Channelization may be extensive; embankments or shoring structures present on both banks; and 40 to 80% of stream reach channelized and disrupted.					Banks shored with gabion or cement; over 80% of the stream reach channelized and disrupted. Instream habitat greatly altered or removed entirely.				
	20	19	18	17	16	15	14	13	12	11	10	9	8	7	6	5	4	3	2	1
7. Frequency of Riffles (or bends) SCORE 19	Occurrence of riffles relatively frequent; ratio of distance between riffles divided by width of the stream <7:1 (generally 5 to 7); variety of habitat is key. In streams where riffles are continuous, placement of boulders or other large, natural obstruction is important.					Occurrence of riffles infrequent; distance between riffles divided by the width of the stream is between 7 to 15.					Occasional riffle or bend; bottom contours provide some habitat; distance between riffles divided by the width of the stream is between 15 to 25.					Generally all flat water or shallow riffles; poor habitat; distance between riffles divided by the width of the stream is a ratio of >25.				
	20	19	18	17	16	15	14	13	12	11	10	9	8	7	6	5	4	3	2	1
8. Bank Stability (score each bank) Note: determine left or right side by facing downstream. SCORE 10 SCORE 10	Banks stable; evidence of erosion or bank failure absent or minimal; little potential for future problems. <5% of bank affected.					Moderately stable; infrequent, small areas of erosion mostly healed over. 5-30% of bank in reach has areas of erosion.					Moderately unstable; 30-60% of bank in reach has areas of erosion; high erosion potential during floods.					Unstable; many eroded areas; "raw" areas frequent along straight sections and bends; obvious bank sloughing; 60-100% of bank has erosional scars.				
	Left Bank	10	9			8	7	6			5	4	3			2	1	0		
	Right Bank	10	9			8	7	6			5	4	3			2	1	0		
9. Vegetative Protection (score each bank) SCORE 10 SCORE 10	More than 90% of the streambank surfaces and immediate riparian zone covered by native vegetation, including trees, understory shrubs, or nonwoody macrophytes; vegetative disruption through grazing or mowing minimal or not evident; almost all plants allowed to grow naturally.					70-90% of the streambank surfaces covered by native vegetation, but one class of plants is not well-represented; disruption evident but not affecting full plant growth potential to any great extent; more than one-half of the potential plant stubble height remaining.					50-70% of the streambank surfaces covered by vegetation; disruption obvious; patches of bare soil or closely cropped vegetation common; less than one-half of the potential plant stubble height remaining.					Less than 50% of the streambank surfaces covered by vegetation; disruption of streambank vegetation is very high; vegetation has been removed to 5 centimeters or less in average stubble height.				
	Left Bank	10	9			8	7	6			5	4	3			2	1	0		
	Right Bank	10	9			8	7	6			5	4	3			2	1	0		
10. Riparian Vegetative Zone Width (score each bank riparian zone) SCORE 10 SCORE 10	Width of riparian zone >18 meters; human activities (i.e., parking lots, roadbeds, clear-cuts, lawns, or crops) have not impacted zone.					Width of riparian zone 12-18 meters; human activities have impacted zone only minimally.					Width of riparian zone 6-12 meters; human activities have impacted zone a great deal.					Width of riparian zone <6 meters; little or no riparian vegetation due to human activities.				
	Left Bank	10	9			8	7	6			5	4	3			2	1	0		
	Right Bank	10	9			8	7	6			5	4	3			2	1	0		

Parameters to be evaluated broader than sampling reach

Total Score 187

Notes:

BENTHIC MACROINVERTEBRATE FIELD DATA SHEET

STREAM NAME S-EF57		LOCATION Roanoke County	
STATION # 281.02	RIVERMILE	STREAM CLASS Intermittent	
LAT 37.181736	LONG -80.148948	RIVER BASIN Upper Roanoke	
STORET #		AGENCY VADEQ	
INVESTIGATORS AB / KB		LOT NUMBER	
FORM COMPLETED BY AB / KB		DATE 1/14/2022 TIME 11:29AM	REASON FOR SURVEY Baseline Assessment

HABITAT TYPES	Indicate the percentage of each habitat type present <input type="checkbox"/> Cobble ____% <input type="checkbox"/> Snags ____% <input type="checkbox"/> Vegetated Banks ____% <input type="checkbox"/> Sand ____% <input type="checkbox"/> Submerged Macrophytes ____% <input type="checkbox"/> Other (_____) ____%
SAMPLE COLLECTION	Gear used <input type="checkbox"/> D-frame <input type="checkbox"/> kick-net <input type="checkbox"/> Other _____ How were the samples collected? <input type="checkbox"/> wading <input type="checkbox"/> from bank <input type="checkbox"/> from boat Indicate the number of jabs/kicks taken in each habitat type. <input type="checkbox"/> Cobble ____ <input type="checkbox"/> Snags ____ <input type="checkbox"/> Vegetated Banks ____ <input type="checkbox"/> Sand ____ <input type="checkbox"/> Submerged Macrophytes ____ <input type="checkbox"/> Other (_____) ____
GENERAL COMMENTS	Benthics not collected due to lack of riffle habitat within assessed reach.

QUALITATIVE LISTING OF AQUATIC BIOTA

Indicate estimated abundance: 0 = Absent/Not Observed, 1 = Rare, 2 = Common, 3= Abundant, 4 = Dominant

Periphyton	0	1	2	3	4	Slimes	0	1	2	3	4
Filamentous Algae	0	1	2	3	4	Macroinvertebrates	0	1	2	3	4
Macrophytes	0	1	2	3	4	Fish	0	1	2	3	4

FIELD OBSERVATIONS OF MACROBENTHOS

Indicate estimated abundance: 0 = Absent/Not Observed, 1 = Rare (1-3 organisms), 2 = Common (3-9 organisms), 3= Abundant (>10 organisms), 4 = Dominant (>50 organisms)

Porifera	0	1	2	3	4	Anisoptera	0	1	2	3	4	Chironomidae	0	1	2	3	4
Hydrozoa	0	1	2	3	4	Zygoptera	0	1	2	3	4	Ephemeroptera	0	1	2	3	4
Platyhelminthes	0	1	2	3	4	Hemiptera	0	1	2	3	4	Trichoptera	0	1	2	3	4
Turbellaria	0	1	2	3	4	Coleoptera	0	1	2	3	4	Other	0	1	2	3	4
Hirudinea	0	1	2	3	4	Lepidoptera	0	1	2	3	4						
Oligochaeta	0	1	2	3	4	Sialidae	0	1	2	3	4						
Isopoda	0	1	2	3	4	Corydalidae	0	1	2	3	4						
Amphipoda	0	1	2	3	4	Tipulidae	0	1	2	3	4						
Decapoda	0	1	2	3	4	Empididae	0	1	2	3	4						
Gastropoda	0	1	2	3	4	Simuliidae	0	1	2	3	4						
Bivalvia	0	1	2	3	4	Tabinidae	0	1	2	3	4						
						Culcidae	0	1	2	3	4						

WOLMAN PEBBLE COUNT FORM

County: Roanoke County Stream ID: S-E57
 Stream Name: UNT to Bottom Creek
 HUC Code: 03010101 Basin: Upper Roanoke
 Survey Date: 1/14/2022
 Surveyors: AB and KB
 Type: Representative Bankfull

PEBBLE COUNT							
Inches	PARTICLE	Millimeters		Particle Count	Total #	Item %	% Cum
	Silt/Clay	< .062	S/C	▲ ▼	0	0.00	0.00
	Very Fine	.062-.125	S A N D	▲ ▼	1	1.00	1.00
	Fine	.125-.25		▲ ▼	0	0.00	1.00
	Medium	.25-.5		▲ ▼	0	0.00	1.00
	Coarse	.50-1.0		▲ ▼	10	10.00	11.00
.04-.08	Very Coarse	1.0-2		▲ ▼	9	9.00	20.00
.08-.16	Very Fine	2-4		G R A V E L	▲ ▼	11	11.00
.16-.22	Fine	4-5.7	▲ ▼		7	7.00	38.00
.22-.31	Fine	5.7-8	▲ ▼		7	7.00	45.00
.31-.44	Medium	8-11.3	▲ ▼		1	1.00	46.00
.44-.63	Medium	11.3-16	▲ ▼		4	4.00	50.00
.63-.89	Coarse	16-22.6	▲ ▼		1	1.00	51.00
.89-1.26	Coarse	22.6-32	▲ ▼		4	4.00	55.00
1.26-1.77	Vry Coarse	32-45	▲ ▼		1	1.00	56.00
1.77-2.5	Vry Coarse	45-64	▲ ▼		1	1.00	57.00
2.5-3.5	Small	64-90	C O B B L E		▲ ▼	6	6.00
3.5-5.0	Small	90-128		▲ ▼	9	9.00	72.00
5.0-7.1	Large	128-180		▲ ▼	14	14.00	86.00
7.1-10.1	Large	180-256		▲ ▼	11	11.00	97.00
10.1-14.3	Small	256-362	B O U L D E R	▲ ▼	2	2.00	99.00
14.3-20	Small	362-512		▲ ▼	1	1.00	100.00
20-40	Medium	512-1024		▲ ▼	0	0.00	100.00
40-80	Large	1024-2048		▲ ▼	0	0.00	100.00
80-160	Vry Large	2048-4096		▲ ▼	0	0.00	100.00
	Bedrock		BDRK	▲ ▼	0	0.00	100.00
				Totals	100		
Total Tally:							

RIVERMORPH PARTICLE SUMMARY

 River Name: UNT to Bottom Creek
 Reach Name: S-EF57
 Sample Name: Representative Bankfull
 Survey Date: 01/14/2022

Size (mm)	TOT #	ITEM %	CUM %
0 - 0.062	0	0.00	0.00
0.062 - 0.125	1	1.00	1.00
0.125 - 0.25	0	0.00	1.00
0.25 - 0.50	0	0.00	1.00
0.50 - 1.0	10	10.00	11.00
1.0 - 2.0	9	9.00	20.00
2.0 - 4.0	11	11.00	31.00
4.0 - 5.7	7	7.00	38.00
5.7 - 8.0	7	7.00	45.00
8.0 - 11.3	1	1.00	46.00
11.3 - 16.0	4	4.00	50.00
16.0 - 22.6	1	1.00	51.00
22.6 - 32.0	4	4.00	55.00
32 - 45	1	1.00	56.00
45 - 64	1	1.00	57.00
64 - 90	6	6.00	63.00
90 - 128	9	9.00	72.00
128 - 180	14	14.00	86.00
180 - 256	11	11.00	97.00
256 - 362	2	2.00	99.00
362 - 512	1	1.00	100.00
512 - 1024	0	0.00	100.00
1024 - 2048	0	0.00	100.00
Bedrock	0	0.00	100.00

D16 (mm)	1.56
D35 (mm)	4.97
D50 (mm)	16
D84 (mm)	172.57
D95 (mm)	242.18
D100 (mm)	511.98
Silt/Clay (%)	0
Sand (%)	20
Gravel (%)	37
Cobble (%)	40
Boulder (%)	3
Bedrock (%)	0

Total Particles = 100.



Stream Assessment Form (Form 1)

Unified Stream Methodology for use in Virginia

For use in wadeable channels classified as intermittent or perennial

Project #	Project Name (Applicant)	Locality	Cowardin Class.	HUC	Date	SAR #	Impact Length	Impact Factor	
22865.06	Mountain Valley Pipeline (Mountain Valley Pipeline, LLC)	Roanoke County	R4	03010101	8/18/21	S-EF57	42	1	
Name(s) of Evaluator(s)		Stream Name and Information					SAR Length		
SB/KB/ES		UNT to Bottom Creek					42		

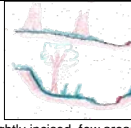
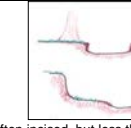
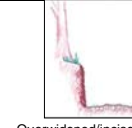
1. Channel Condition: Assess the cross-section of the stream and prevailing condition (erosion, aggradation)

	Conditional Category					
	Optimal	Suboptimal	Marginal	Poor	Severe	
Channel Condition	 Very little incision or active erosion; 80-100% stable banks. Vegetative surface protection or natural rock, prominent (80-100%). AND/OR Stable point bars / bankfull benches are present. Access to their original floodplain or fully developed wide bankfull benches. Mid-channel bars and transverse bars few. Transient sediment deposition covers less than 10% of bottom.	 Slightly incised, few areas of active erosion or unprotected banks. Majority of banks are stable (60-80%). Vegetative protection or natural rock prominent (60-80%) AND/OR Depositional features contribute to stability. The bankfull and low flow channels are well defined. Stream likely has access to bankfull benches, or newly developed floodplains along portions of the reach. Transient sediment covers 10-40% of the stream bottom.	 Often incised, but less than Severe or Poor. Banks more stable than Severe or Poor due to lower bank slopes. Erosion may be present on 40-60% of both banks. Vegetative protection on 40-60% of banks. Streambanks may be vertical or undercut. AND/OR 40-60% Sediment may be temporary / transient, contribute to instability. Deposition that contribute to stability, may be forming/present. AND/OR V-shaped channels have vegetative protection on > 40% of the banks and depositional features which contribute to stability.	 Overwidened/incised. Vertically / laterally unstable. Likely to widen further. Majority of both banks are near vertical. Erosion present on 60-80% of banks. Vegetative protection present on 20-40% of banks, and is insufficient to prevent erosion. AND/OR 60-80% of the stream is covered by sediment. Sediment is temporary / transient in nature, and contributing to instability. AND/OR V-shaped channels have vegetative protection is present on > 40% of the banks and stable sediment deposition is absent.	 Deeply incised (or excavated), vertical/lateral instability. Severe incision, flow contained within the banks. Streambed below average rooting depth, majority of banks vertical/undercut. Vegetative protection present on less than 20% of banks, is not preventing erosion. Obvious bank sloughing present. Erosion/raw banks on 80-100%. AND/OR Aggrading channel. Greater than 80% of stream bed is covered by deposition, contributing to instability. Multiple thread channels and/or subterranean flow.	CI
Scores	3	2.4	2	1.6	1	3.00
NOTES>>						

2. RIPARIAN BUFFERS: Assess both bank's 100 foot riparian areas along the entire SAR. (rough measurements of length & width may be acceptable)

	Conditional Category						NOTES>>		
	Optimal	Suboptimal		Marginal		Poor			
Riparian Buffers	Tree stratum (dbh > 3 inches) present, with > 60% tree canopy cover. Wetlands located within the riparian areas.	High Suboptimal: Riparian areas with tree stratum (dbh > 3 inches) present, with 30% to 60% tree canopy cover and containing both herbaceous and shrub layers or a non-maintained understory.	Low Suboptimal: Riparian areas with tree stratum (dbh > 3 inches) present, with 30% to 60% tree canopy cover and a maintained understory. Recent cutover (dense vegetation).	High Marginal: Non-maintained, dense herbaceous vegetation with either a shrub layer or a tree layer (dbh > 3 inches) present, with <30% tree canopy cover.	Low Marginal: Non-maintained, dense herbaceous vegetation, riparian areas lacking shrub and tree stratum, hay production, ponds, open water. If present, tree stratum (dbh > 3 inches) present, with <30% tree canopy cover with maintained understory.	High Poor: Lawns, mowed, and maintained areas, nurseries; no-till cropland; actively grazed pasture, sparsely vegetated non-maintained area, recently seeded and stabilized, or other comparable condition.	Low Poor: Impervious surfaces, mine spoil lands, denuded surfaces, row crops, active feed lots, trails, or other comparable conditions.		
Scores	1.5	High	Low	High	Low	High	Low		
1. Delineate riparian areas along each stream bank into Condition Categories and Condition Scores using the descriptors. 2. Determine square footage for each by measuring or estimating length and width. Calculators are provided for you below. 3. Enter the % Riparian Area and Score for each riparian category in the blocks below.									
Right Bank	% Riparian Area >	90%	10%				100%		
	Score >	1.5	0.6						
<small>CI = (Sum % RA * Scores*0.01)/2</small>									
Left Bank	% Riparian Area >	90%	10%				100%		
	Score >	1.5	0.6						
							Rt Bank CI >	1.41	CI
							Lt Bank CI >	1.41	1.41

3. INSTREAM HABITAT: Varied substrate sizes, water velocity and depths; woody and leafy debris; stable substrate; low embeddedness; shade; undercut banks; root mats; SAV; riffle/pool complexes, stable features.

	Conditional Category				NOTES>>
	Optimal	Suboptimal	Marginal	Poor	
Instream Habitat/ Available Cover	Habitat elements are typically present in greater than 50% of the reach.	Stable habitat elements are typically present in 30-50% of the reach and are adequate for maintenance of populations.	Stable habitat elements are typically present in 10-30% of the reach and are adequate for maintenance of populations.	Habitat elements listed above are lacking or are unstable. Habitat elements are typically present in less than 10% of the reach.	Stream Gradient
Scores	1.5	1.2	0.9	0.5	High
					CI
					1.50

Stream Impact Assessment Form Page 2

Project #	Project Name (Applicant)	Locality	Cowardin Class.	HUC	Date	SAR #	Impact Length	Impact Factor
22865.06	Mountain Valley Pipeline (Mountain Valley Pipeline, LLC)	Roanoke County	R4	03010101	8/18/21	S-EF57	42	1

4. CHANNEL ALTERATION: Stream crossings, riprap, concrete, gabions, or concrete blocks, straightening of channel, channelization, embankments, spoil piles, constrictions, livestock

Channel Alteration	Conditional Category						NOTES>>
	Negligible	Minor		Moderate	Severe		
Channelization, dredging, alteration, or hardening absent. Stream has an unaltered pattern or has naturalized.	Less than 20% of the stream reach is disrupted by any of the channel alterations listed in the parameter guidelines.	20-40% of the stream reach is disrupted by any of the channel alterations listed in the parameter guidelines.	40 - 60% of reach is disrupted by any of the channel alterations listed in the parameter guidelines. If stream has been channelized, normal stable stream meander pattern has not recovered.	60 - 80% of reach is disrupted by any of the channel alterations listed in the parameter guidelines. If stream has been channelized, normal stable stream meander pattern has not recovered.	Greater than 80% of reach is disrupted by any of the channel alterations listed in the parameter guidelines AND/OR 80% of banks shored with gabion, riprap, or cement.		
Scores	1.5	1.3	1.1	0.9	0.7	0.5	CI

1.50

REACH CONDITION INDEX and STREAM CONDITION UNITS FOR THIS REACH

NOTE: The CIs and RCI should be rounded to 2 decimal places. The CR should be rounded to a whole number.

THE REACH CONDITION INDEX (RCI) >>	1.48
RCI= (Sum of all CI's)/5, except if stream is ephemeral RCI = (Riparian CI/2)	
COMPENSATION REQUIREMENT (CR) >>	62

CR = RCI X L_i X IF

INSERT PHOTOS:

(WSSI Photo Location "L:\22000s\22800\22865.06\Admin\05-ENVR\Field Data\Spread H\Field Forms\S-EF57\Photos\DS VIEW.JPG")



Downstream view facing S. Assessment is limited to areas within the temporary ROW.

DESCRIBE PROPOSED IMPACT:

PROVIDED UNDER SEPARATE COVER

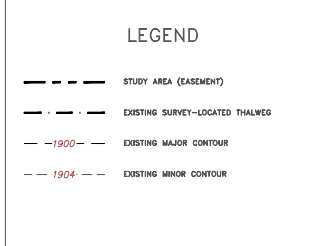
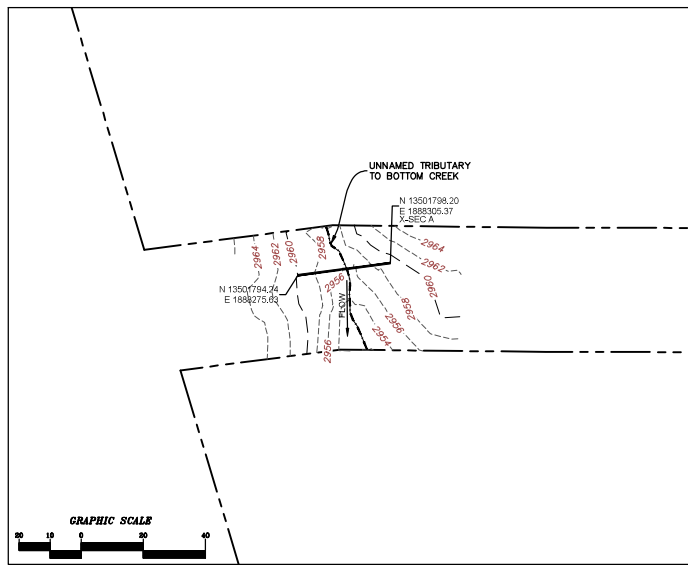

- SURVEY NOTES:
- THIS MAP HAS BEEN ORIENTED TO NAD 1983 UTM ZONE 17N, AND VERTICALLY TO THE NORTH AMERICAN VERTICAL DATUM OF 1988 (NAVD 88), USING REAL TIME DGPS. FIELD LOCATIONS WERE COMPLETED ON AUGUST 19, 2021.
 - EASEMENT LINES SHOWN ON PLAN VIEW WERE PROVIDED BY MOUNTAIN VALLEY PIPELINE.
 - SURVEY POINTS FOR CROSS SECTIONS AND THALWEG PROFILES COLLECTED IN 2021 HAVE BEEN USED IN COMBINATION WITH SURVEY POINTS COLLECTED PREVIOUSLY IN 2020 IN ORDER TO GENERATE THE PRE-CROSSING SURFACE SHOWN IN PLAN. DUE TO NATURAL EROSIONAL STREAM PROCESSES THAT CAN OCCUR OVER TIME, MINOR ADJUSTMENTS TO THE PROFILE ALIGNMENTS MAY HAVE BEEN REQUIRED IN ORDER TO GENERATE A CLEAN PRE-CROSSING SURFACE.
 - ALL SECTION VIEWS SHOWN LEFT TO RIGHT FACING DOWNSTREAM.

No.	Date	Eng.	Revision

CAD File No.
JZ
Drawn
GH
Checked
DW
Approved
NOTED
Scale
SEPT, 2021
Date:
112602157
Project No.

TETRA TECH, INC.
401 ANDERSON DRIVE
PROCTOR PLAZA 7
ROANOKE, VA 24060
TEL: (410) 881-1000
F-Mail Address: WWW.TETRA-TECH.COM

TETRA TECH
www.tetra-tech.com

Client
MOUNTAIN VALLEY PIPELINE, LLC
2200 ENERGY DRIVE, 2ND FLOOR
CANONSBURG, PA 15317

File
PROFILE AND CROSS-SECTIONS
BASELINE SURVEY
CROSSING S-EF57 - UNNAMED TRIBUTARY
TO BOTTOM CREEK (WP 241.10)
ROANOKE COUNTY, VA

S-EF57 BASELINE CROSS-SECTION A

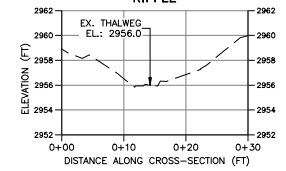

S-EF57 BASELINE THALWEG PROFILE

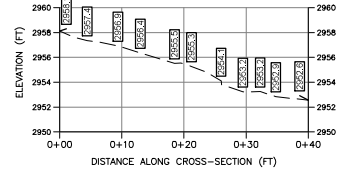

PROFILE LEGEND

- - - EXISTING STREAM PROFILE
- - - INVERT ALONG THALWEG

PROFILE
SCALE: H: 1"=10'
V: 1"=5'

CL STAKEOUT POINTS: S-EF57 CROSS SECTION A (RIFFLE)

PT. LOC.	PRE-CROSSING			POST-CROSSING	
	NORTHING	EASTING	ELEV.	VERT. DIFF.	HORZ. DIFF.
TS-L	13503796.4660	1888295.5200	2956.487		
BS-L	13503796.2150	1888294.2870	2955.970		
THW	13503795.5290	1888291.6700	2955.855		
BS-R	13503795.1130	1888289.7430	2956.057		
TS-R	13503795.0170	1888289.4580	2956.338		

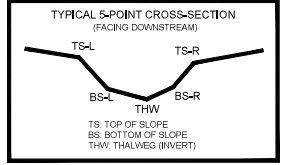

CROSS SECTION LEGEND

- - - EXISTING GRADE

CROSS SECTION

SCALE: H: 1"=10'
V: 1"=5'

NOTE: ALL SECTIONS VIEWS SHOWN LEFT TO RIGHT FACING DOWNSTREAM.

PRE-CROSSING PHOTOS



POST-CROSSING PHOTOS

