

Project Name: Mountain Valley Pipeline Project  
Date: 11/10/2015  
Location: Red Covered Bridge,  
129 Covered Bridge Lane,  
Newport, Giles County, Virginia  
Site No. 035-0412-0245/035-0005

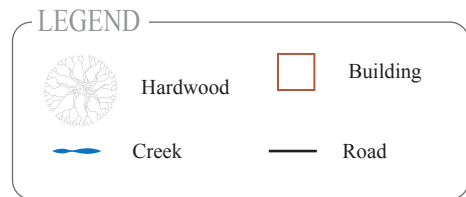

Site Map for Red Covered Bridge (035-0412-0245/035-0005)





**Red Covered Bridge (035-0412-0245/035-0005), 129 Covered Bridge Lane, View North**



**Red Covered Bridge (035-0412-0245/035-0005), 129 Covered Bridge Lane, Setting,  
View Northwest**





**Red Covered Bridge (035-0412-0245/035-0005), 129 Covered Bridge Lane, View North**



**Red Covered Bridge (035-0412-0245/035-0005), 129 Covered Bridge Lane,  
View Northwest**





**Red Covered Bridge (035-0412-0245/035-0005), 129 Covered Bridge Lane, View West**



Project Name: Mountain Valley Pipeline Project  
Date: 11/10/2015  
Location: Link Farm,  
100 Covered Bridge Lane,  
Newport, Giles County, Virginia  
Site No. 035-0412-0244

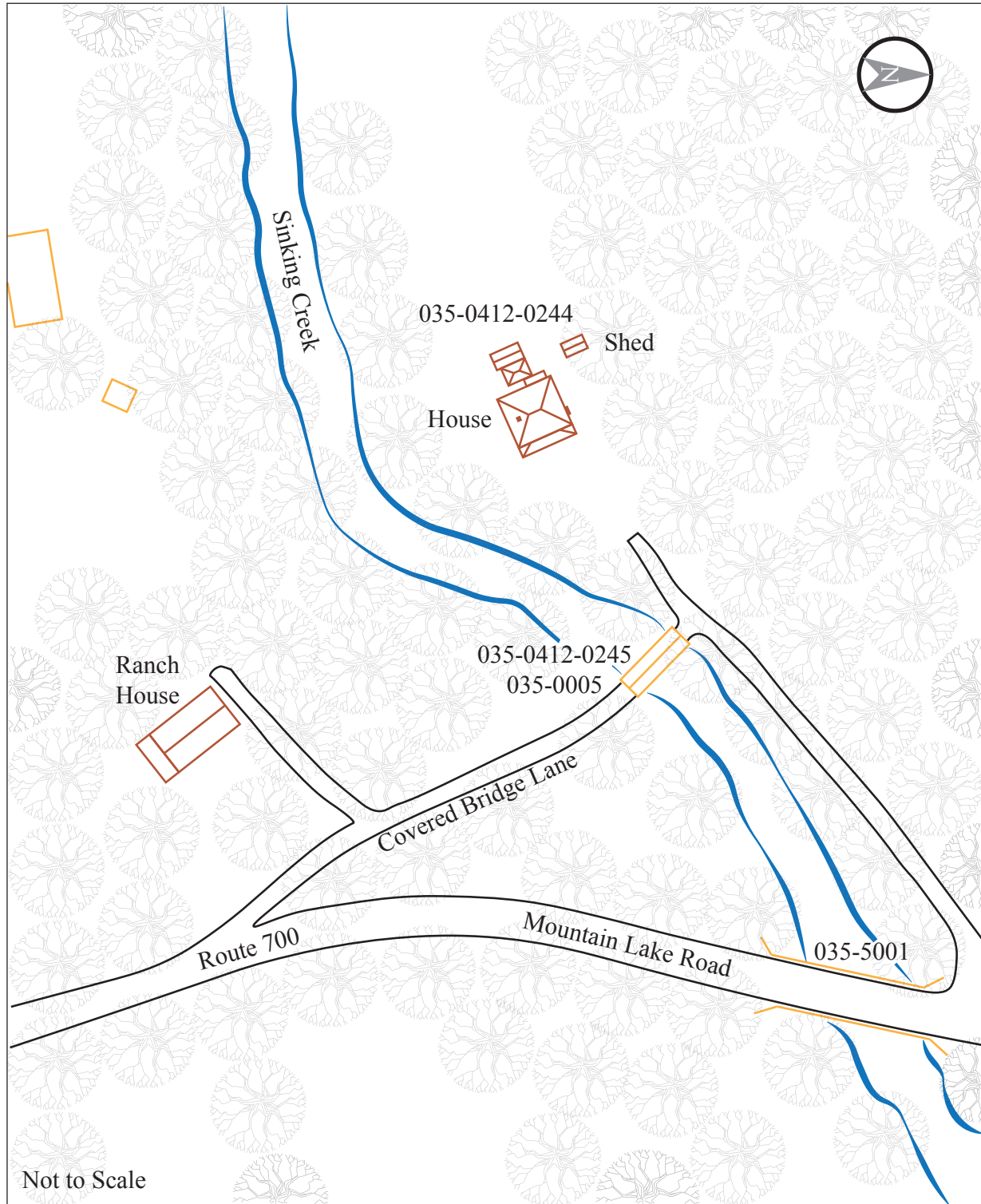
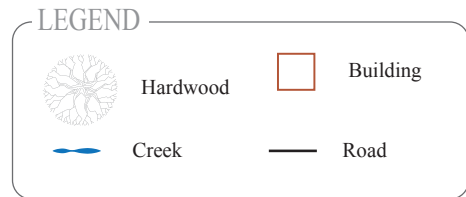

Site Map for the Link Farm (035-0412-0244)





**Link Farm (035-0412-0244), 100 Covered Bridge Lane,  
View Northwest**





**Link Farm (035-0412-0244), 100 Covered Bridge Lane, Setting,  
View Northwest**





Project Name: Mountain Valley Pipeline Project  
Date: 09/20/2015  
Location: Cemetery, 133 Mountain Lake Road (Route 700),  
Newport, Giles County, Virginia  
Site No. 035-0412-0465

LEGEND

Hardwood

Grave Marker

Building

Fence

Road,  
Driveway

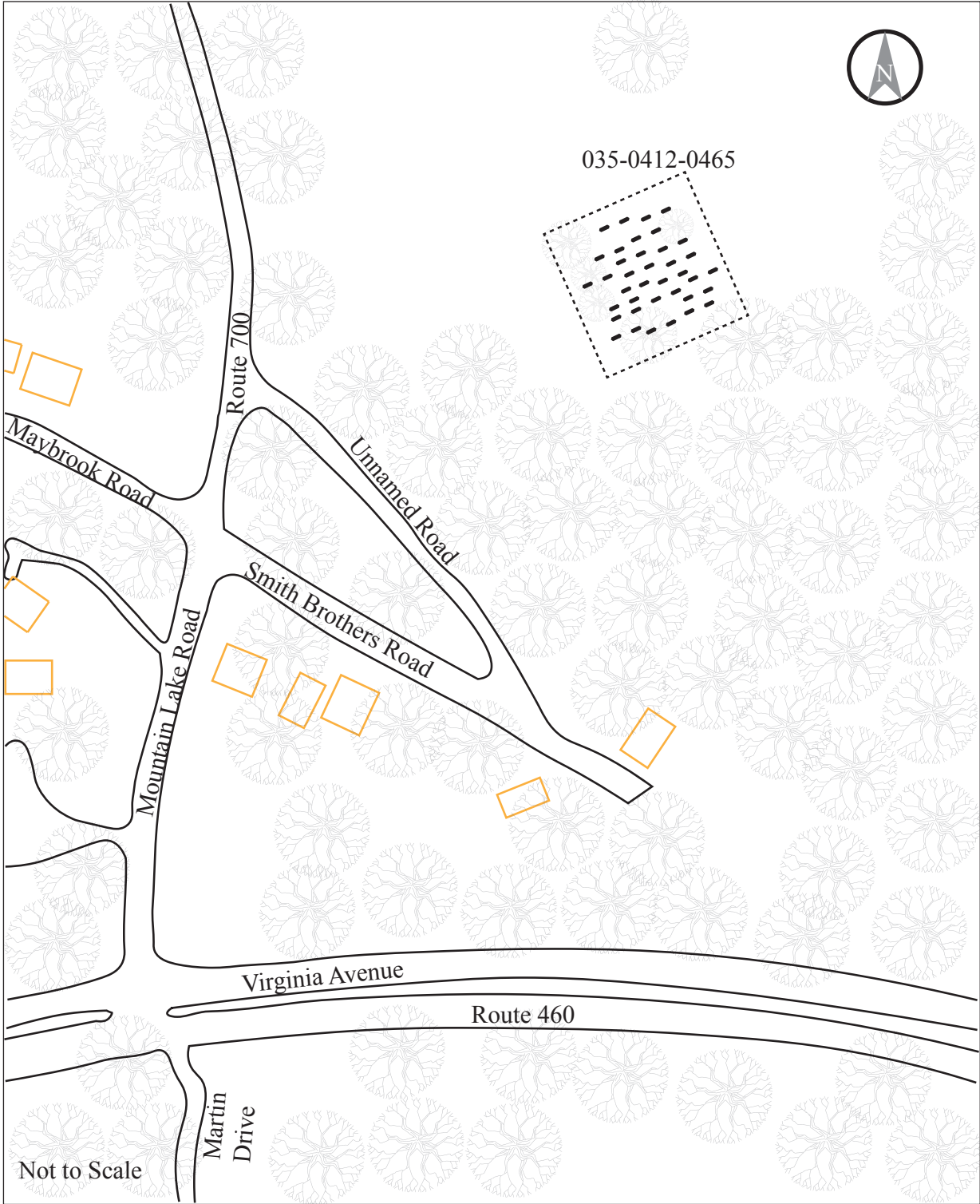

Site Map for Cemetery (035-0412-0465)





**Cemetery (035-0412-0465), 133 Mountain Lake Road (Route 700),  
View Northeast**



**Cemetery (035-0412-0465), 133 Mountain Lake Road (Route 700),  
View Northeast**



Project Name: Mountain Valley Pipeline Project  
 Date: 05/30/2015  
 Location: Road Trace, 428 Steele Acres Road  
 (Route 700), Newport, Giles County, Virginia  
 Site No. 035-0412-0466

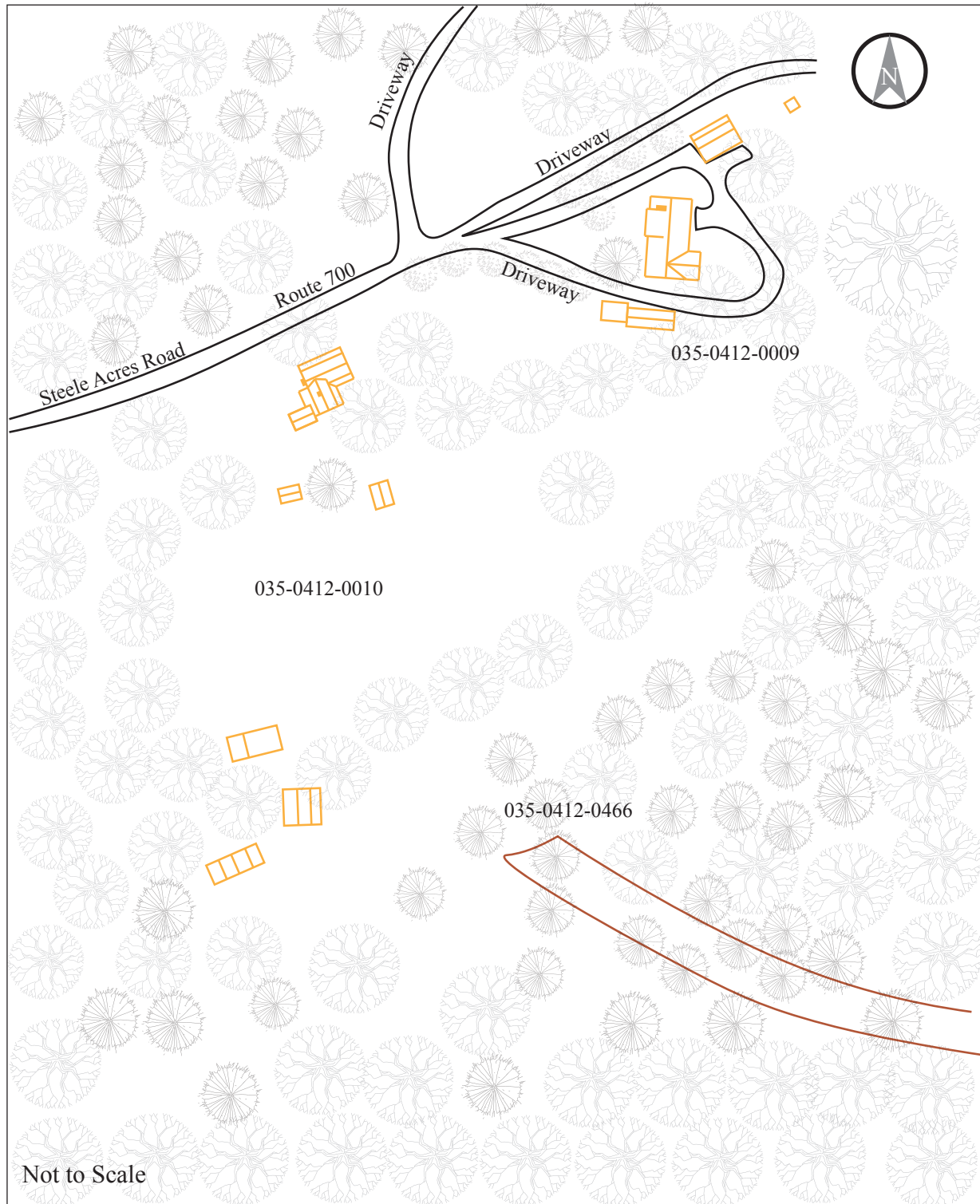
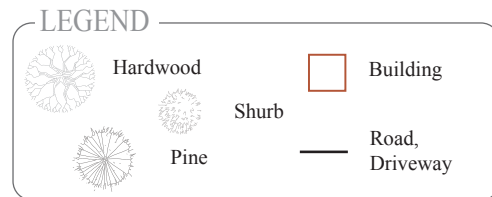

**Site Map for Road Trace on Adlie Jones Farm (035-0412-0466)**





**Road Trace on Adlie Jones Farm (035-0412-0466), 428 Steele Acres Road (Route 615),  
Setting, View West**



Project Name: Mountain Valley Pipeline Project  
 Date: 11/10/2015  
 Location: Sinking Creek Bridge #6052,  
 Mountain Lake Road (Route 700),  
 Newport, Giles County, Virginia  
 Site No. 035-5001

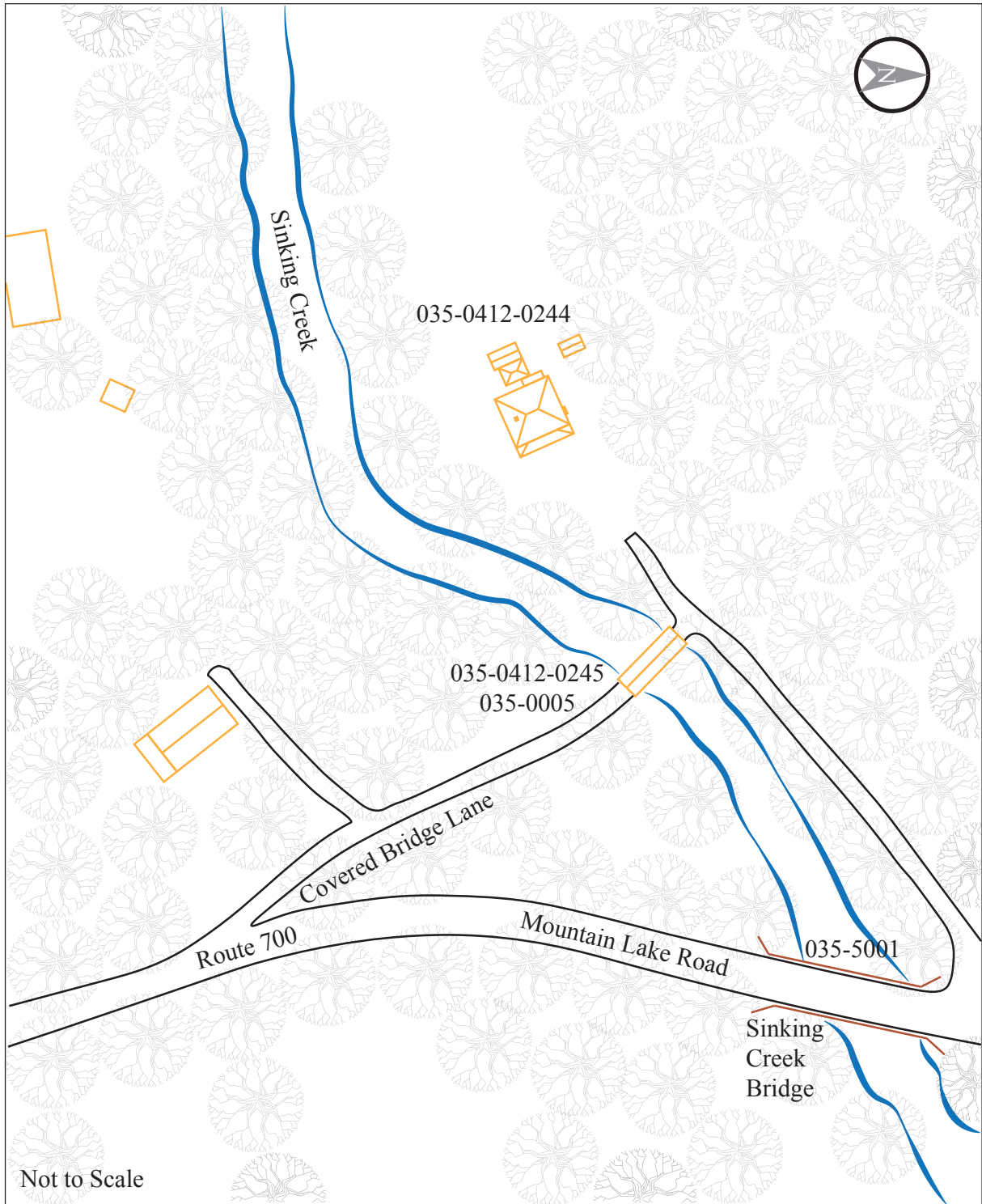
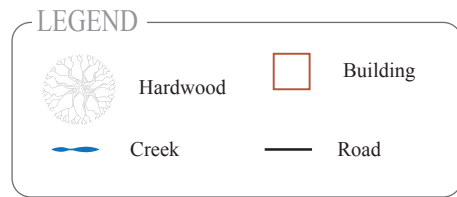

**Site Map of Sking Creek Bridge #6052 (035-5001)**



**Photographs Not Available**